

ELECTRICMATE

Power Perfected



PRODUCT CATALOGUE



POWER PERFECTED

ELECTRICMATE offers high quality electrical products, perfect for both businesses and homes alike. We offer a wide range of electrical products for all your electrical solutions. **ELECTRICMATE** is the ideal cost-effective solution.

As a distributor, **GENTECH INDUSTRIES** promotes ethical sourcing and complies with an international programme that outlines and monitors these standards. Maintaining a strong relationship with our local and international business partners enables us to satisfy the needs and preferences of our clients and stay abreast of the market trends within this industry.

Our international manufacturing partners are ISO9001 accredited and our products meet and comply with all the necessary local compliance standards.

A surge is an abnormal but temporary jolt of high voltage on the electrical mains. This can be caused by non-direct lightning strikes or from noise possibly produced by the use of heavy-duty appliances, heavy-duty machinery or large power tools. Don't risk losing your valuable equipment through surges! Protect them with the **ELECTRICMATE** Surge Safe, **SAFEHOUSE** accredited products.





1 YEAR WARRANTY



EA001
**TOP ENTRY
EUROMATE
ADAPTOR**
6009880599370



EA002
**TOP & BOTTOM
ENTRY EUROMATE
ADAPTOR**
6009880599387



EA003
**TRIPLE
EUROMATE
ADAPTOR**
6009880599394



EA004
**SCHUKO
ADAPTOR**
6009880599400



EA005
**SCHUKO &
EUROMATE
ADAPTOR**
6009880599417





Colour RANGE

TOP ENTRY EUROMATE ADAPTOR



PRODUCT CODE	DESCRIPTION	ITEM BARCODE	FEATURES
EA001P	SINGLE EUROMATE ADAPTOR – PINK	6009880968497	SAFETY SHUTTERED
EA001BL	SINGLE EUROMATE ADAPTOR – BLUE	6009880968503	
EA001OR	SINGLE EUROMATE ADAPTOR – ORANGE	6009880968510	
EA001GR	SINGLE EUROMATE ADAPTOR – GREEN	6009880968527	
EA001BLK	SINGLE EUROMATE ADAPTOR – BLACK	6009880968534	

Colour RANGE



1 YEAR
WARRANTY

TOP & BOTTOM ENTRY EUROMATE ADAPTOR



PRODUCT CODE	DESCRIPTION	ITEM BARCODE	FEATURES
EA002P	TWIN EUROMATE ADAPTOR – PINK	6009880968541	SAFETY SHUTTERED
EA002BL	TWIN EUROMATE ADAPTOR – BLUE	6009880968558	
EA002OR	TWIN EUROMATE ADAPTOR – ORANGE	6009880968565	
EA002GR	TWIN EUROMATE ADAPTOR – GREEN	6009880968572	
EA002BLK	TWIN EUROMATE ADAPTOR – BLACK	6009880968589	

COLOUR RANGE | MULTIPUGGS & ADAPTORS



1 YEAR WARRANTY

Colour RANGE

TRIPLE EUROMATE ADAPTOR



PRODUCT CODE	DESCRIPTION	ITEM BARCODE	FEATURES
EA003P	TRIPLE EUROMATE ADAPTOR – PINK	6009880968596	SAFETY SHUTTERED
EA003BL	TRIPLE EUROMATE ADAPTOR – BLUE	6009880968602	
EA003OR	TRIPLE EUROMATE ADAPTOR – ORANGE	6009880968619	
EA003GR	TRIPLE EUROMATE ADAPTOR – GREEN	6009880968626	
EA003BLK	TRIPLE EUROMATE ADAPTOR – BLACK	6009880968633	

Colour

RANGE



1 YEAR
WARRANTY

SCHUKO ADAPTOR



COLOUR RANGE | MULTIPLUGS & ADAPTORS

PRODUCT CODE	DESCRIPTION	ITEM BARCODE	FEATURES
EA002P	SCHUKO ADAPTOR – PINK	6009880968640	SAFETY SHUTTERED
EA002BL	SCHUKO ADAPTOR – BLUE	6009880968657	
EA002OR	SCHUKO ADAPTOR – ORANGE	6009880968664	
EA002GR	SCHUKO ADAPTOR – GREEN	6009880968671	
EA002BLK	SCHUKO ADAPTOR – BLACK	6009880968688	



1 YEAR WARRANTY

Colour RANGE

SCHUKO & EUROMATE ADAPTOR



PRODUCT CODE	DESCRIPTION	ITEM BARCODE	FEATURES
EA005P	SCHUKO & EUROMATE ADAPTOR – PINK	6009880968695	SAFETY SHUTTERED
EA005BL	SCHUKO & EUROMATE ADAPTOR – BLUE	6009880968701	
EA005OR	SCHUKO & EUROMATE ADAPTOR – ORANGE	6009880968718	
EA005GR	SCHUKO & EUROMATE ADAPTOR – GREEN	6009880968725	
EA005BLK	SCHUKO & EUROMATE ADAPTOR – BLACK	6009880968732	



**1 YEAR
WARRANTY**

EA006L
2 x 16 AMP ADAPTOR
6009880599424



EA007L
3 x 16 AMP ADAPTOR
6009880599431



EA008L
**1 x 16 AMP + 2 x 5 AMP
ADAPTOR**
6009880599448



EA009L
**1 x 16 AMP + 2 x 5 AMP + 1 x SCHUKO
ADAPTOR**
6009880599462

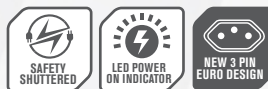

EA010L
**2 x 16 AMP + 2 x 5 AMP
ADAPTOR**
6009880599486



EA011L
**1 x 16 AMP + 1 x 5 AMP + 1 x SCHUKO +
2.1 AMP USB ADAPTOR**
6009880599509



Individually packaged Adaptors



EA015
1 x 16 AMP + 1 x SCHUKO
 HIGH LEVEL SURGE
 PROTECTED ADAPTOR
 6009880343140



EA008S
1 x 16 AMP + 2 x 5 AMP
 ADAPTOR WITH MEDIUM
 SURGE PROTECTION
 6009880599455



EA009S
1 x 16 AMP + 2 x 5 AMP + 1 x SCHUKO
 ADAPTOR WITH MEDIUM
 SURGE PROTECTION
 6009880599479



EA010S
2 x 16 AMP + 2 x 5 AMP
 ADAPTOR WITH MEDIUM
 SURGE PROTECTION
 6009880599493



EA011S
1 x 16 AMP + 1 x 5 AMP + 1 x SCHUKO +
2.1 AMP USB ADAPTOR WITH MEDIUM
 SURGE PROTECTION
 6009880599516



Colour RANGE



1 YEAR
WARRANTY

1 X 16 AMP + 2 X 5 AMP ADAPTOR

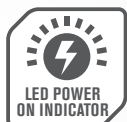

PRODUCT CODE	DESCRIPTION	ITEM BARCODE	FEATURES
EA008P	1 X 16 AMP + 2 X 5 AMP 3 PIN ADAPTOR – PINK	6009880968749	SAFETY SHUTTERED / NEW 3 PIN EURO DESIGN / LED POWER ON INDICATOR
EA008BL	1 X 16 AMP + 2 X 5 AMP 3 PIN ADAPTOR – BLUE	6009880968756	
EA008OR	1 X 16 AMP + 2 X 5 AMP 3 PIN ADAPTOR – ORANGE	6009880968763	
EA008GR	1 X 16 AMP + 2 X 5 AMP 3 PIN ADAPTOR – GREEN	6009880968770	
EA008BLK	1 X 16 AMP + 2 X 5 AMP 3 PIN ADAPTOR – BLACK	6009880968787	

COLOUR RANGE | MULTIPLUGS & ADAPTORS



Colour RANGE

1 X 16 AMP + 2 X 5 AMP + 1 X SCHUKO ADAPTOR

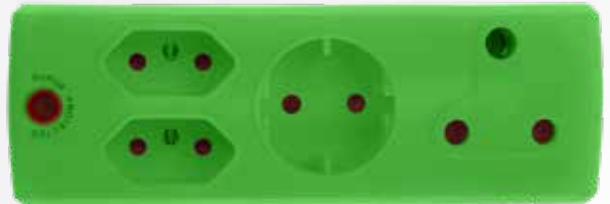

PRODUCT CODE	DESCRIPTION	ITEM BARCODE	FEATURES
EA005P	SCHUKO & EUROMATE ADAPTOR – PINK	6009880968695	SAFETY SHUTTERED / NEW 3 PIN EURO DESIGN / LED POWER ON INDICATOR
EA005BL	SCHUKO & EUROMATE ADAPTOR – BLUE	6009880968701	
EA005OR	SCHUKO & EUROMATE ADAPTOR – ORANGE	6009880968718	
EA005GR	SCHUKO & EUROMATE ADAPTOR – GREEN	6009880968725	
EA005BLK	SCHUKO & EUROMATE ADAPTOR – BLACK	6009880968732	

Colour

RANGE



1 YEAR
WARRANTY

2 X 16 AMP & 2 X 5 AMP ADAPTOR



COLOUR RANGE | MULTIPLUGS & ADAPTORS

PRODUCT CODE	DESCRIPTION	ITEM BARCODE	FEATURES
EA0010P	2 X 16 AMP + 2 X 5 AMP 3 PIN ADAPTOR – PINK	6009880968848	SAFETY SHUTTERED / NEW 3 PIN EURO DESIGN / LED POWER ON INDICATOR
EA0010BL	2 X 16 AMP + 2 X 5 AMP 3 PIN ADAPTOR – BLUE	6009880968855	
EA0010OR	2 X 16 AMP + 2 X 5 AMP 3 PIN ADAPTOR – ORANGE	6009880968862	
EA0010GR	2 X 16 AMP + 2 X 5 AMP 3 PIN ADAPTOR – GREEN	6009880968879	
EA0010BLK	2 X 16 AMP + 2 X 5 AMP 3 PIN ADAPTOR – BLACK	6009880968886	



Colour RANGE

**1 X 16 AMP + 1 X 5 AMP
+ 1 X SCHUKO + 2.1 AMP USB
ADAPTOR**



PRODUCT CODE	DESCRIPTION	ITEM BARCODE	FEATURES
EA0011P	1X 16 AMP + 1 X 5 AMP + 1 X SCHUKO + 2.1 AMP USB ADAPTOR – PINK	6009880968893	SAFETY SHUTTERED / NEW 3 PIN EURO DESIGN / LED POWER ON INDICATOR / USB SOCKET
EA0011BL	1X 16 AMP + 1 X 5 AMP + 1 X SCHUKO + 2.1 AMP USB ADAPTOR – BLUE	6009880968909	
EA0011OR	1X 16 AMP + 1 X 5 AMP + 1 X SCHUKO + 2.1 AMP USB ADAPTOR – ORANGE	6009880968916	
EA0011GR	1X 16 AMP + 1 X 5 AMP + 1 X SCHUKO + 2.1 AMP USB ADAPTOR – GREEN	6009880968923	
EA0011BLK	1X 16 AMP + 1 X 5 AMP + 1 X SCHUKO + 2.1 AMP USB ADAPTOR – BLACK	6009880968930	



**1 YEAR
WARRANTY**

JANUS COUPLERS



JC-01
**HEAVY DUTY RUBBER
JANUS COUPLER**
6009880599547



Led Power On Indicator



EA012L
**NYLON DOUBLE
JANUS COUPLER
WHITE**
6009880599523

Led Power On Indicator



EA012L/BL
**NYLON DOUBLE
JANUS COUPLER
BLACK**
6009880599530

Led Power On Indicator





1 YEAR WARRANTY

PT-01

16 AMP HEAVY DUTY RUBBER PLUG TOP

6009880599554



EPT02

16 AMP HOLLOW PIN WHITE PLUG TOP

6009880599561



EPT02/BL

16 AMP HOLLOW PIN BLACK PLUG TOP

6009880599578



EPT03

16 AMP SOLID BRASS PIN - WHITE PLUG TOP

6009880599592



EPT03/BL

16 AMP SOLID BRASS PIN - BLACK PLUG TOP

6009880599585



Colour RANGE



1 YEAR
WARRANTY

16 AMP HOLLOW PIN PLUG TOP

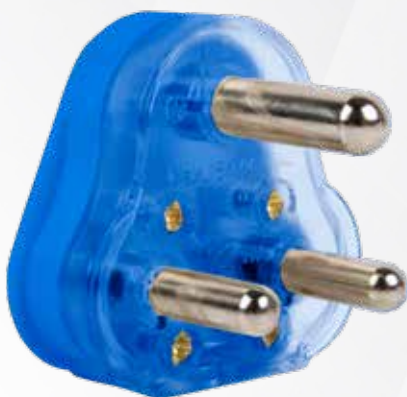

PRODUCT CODE	DESCRIPTION	ITEM BARCODE	FEATURES
EPT02/OR	16 AMP HOLLOW PIN PLUG TOP LOOSE – ORANGE	6009880968947	SOLID BRASS SCREWS
EPT02/GR	16 AMP HOLLOW PIN PLUG TOP LOOSE – GREEN	6009880968954	
EPT02/BLU	16 AMP HOLLOW PIN PLUG TOP LOOSE – BLUE	6009880968961	
EPT02/YE	16 AMP HOLLOW PIN PLUG TOP LOOSE – YELLOW	6009880968978	

COLOUR RANGE | PLUG TOP



1 YEAR WARRANTY

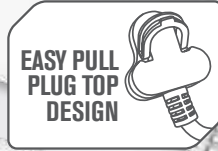

CRE030
4-WAY MULTIPLUG
WITH OVERLOAD PROTECTION
6009880599684



CRE034
6-WAY MULTIPLUG
WITH OVERLOAD PROTECTION
6009880599691



CRE012
8-WAY SWITCHED MULTIPLUG
WITH OVERLOAD PROTECTION
6009880599622



CRE024
12-WAY SWITCHED MULTIPLUG
WITH OVERLOAD PROTECTION
6009880599653





1 YEAR WARRANTY

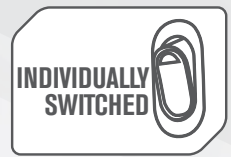

MULTIPLUGS | SWITCHED

MP8S

8-WAY SWITCHED MULTIPLUG
WITH OVERLOAD PROTECTION

6009880599608



MP12S

12-WAY SWITCHED MULTIPLUG
WITH OVERLOAD PROTECTION

6009880599615



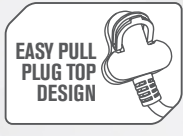

CRE013
8-WAY SWITCHED MULTIPLUG
 WITH MEDIUM SURGE PROTECTION
 6009880599639

CRE014
8-WAY SWITCHED USB MULTIPLUG
 WITH MEDIUM SURGE PROTECTION
 6009880599646



CRE025
12-WAY SWITCHED MULTIPLUG
 WITH MEDIUM SURGE PROTECTION
 6009880599660



CRE026
12-WAY SWITCHED USB MULTIPLUG
 WITH MEDIUM SURGE PROTECTION
 6009880599677



Colour RANGE



1 YEAR
WARRANTY

6-WAY MULTIPLUG WITH OVERLOAD PROTECTION



PRODUCT CODE	DESCRIPTION	ITEM BARCODE	FEATURES
CRE034P	6 WAY MULTIPLUG WITH OVERLOAD PROTECTION – PINK	6009881090036	SAFETY SHUTTERED / LED POWER ON INDICATOR / OVERLOAD PROTECTION / NEW 3 PIN EURO DESIGN / EASY PULL PLUG TOP DESIGN
CRE034BL	6 WAY MULTIPLUG WITH OVERLOAD PROTECTION – BLUE	6009881090043	
CRE034OR	6 WAY MULTIPLUG WITH OVERLOAD PROTECTION – ORANGE	6009881090050	
CRE034GR	6 WAY MULTIPLUG WITH OVERLOAD PROTECTION – GREEN	6009881090067	
CRE034BLK	6 WAY MULTIPLUG WITH OVERLOAD PROTECTION – BLACK	6009881090074	

COLOUR RANGE | MULTIPLUGS & ADAPTORS

LIGHT DUTY EXTENSION LEADS



1 YEAR WARRANTY



COMPATIBLE APPLIANCES



DO NOT OVERLOAD

1mm CORD



PRODUCT CODE	DESCRIPTION	ITEM BARCODE	FEATURES
EE022	3m EXTENSION LEAD 10 AMP	6009880599783	SAFETY SHUTTERED LED POWER ON INDICATOR
EE023	5m EXTENSION LEAD 10 AMP	6009880599790	
EE024	10m EXTENSION LEAD 10 AMP	6009880599806	
EE025	20m EXTENSION LEAD 10 AMP	6009880599813	



1 YEAR WARRANTY

MEDIUM DUTY EXTENSION LEADS



1.5mm CORD



COMPATIBLE APPLIANCES



DO NOT OVERLOAD

PRODUCT CODE	DESCRIPTION	ITEM BARCODE	FEATURES
EE018	3m MEDIUM DUTY EXTENSION LEAD 16 AMP	6009880599745	MEDIUM DUTY / SAFETY SHUTTERED LED POWER ON INDICATOR
EE019	5m MEDIUM DUTY EXTENSION LEAD 16 AMP	6009880599752	
EE020	10m MEDIUM DUTY EXTENSION LEAD 16 AMP	6009880599769	
EE021	20m MEDIUM DUTY EXTENSION LEAD 16 AMP	6009880599776	



1 YEAR WARRANTY

Colour RANGE

3M MEDIUM DUTY EXTENSION LEAD 16 AMP



COMPATIBLE APPLIANCES



DO NOT OVERLOAD



1.5mm CORD



PRODUCT CODE	DESCRIPTION	ITEM BARCODE	FEATURES
EE018P	3m MEDIUM DUTY EXTENSION LEAD 16 AMP – PINK	6009881090081	SAFETY SHUTTERED / LED POWER ON INDICATOR / 16 AMP 1.5MM CORD
EE018BL	3m MEDIUM DUTY EXTENSION LEAD 16 AMP – BLUE	6009881090098	
EE018OR	3m MEDIUM DUTY EXTENSION LEAD 16 AMP – ORANGE	6009881090104	
EE018GR	3m MEDIUM DUTY EXTENSION LEAD 16 AMP – GREEN	6009881090111	
EE018BLK	3m MEDIUM DUTY EXTENSION LEAD 16 AMP – BLACK	6009881090128	

Colour RANGE



1 YEAR
WARRANTY

5M MEDIUM DUTY EXTENSION LEAD 16 AMP



1.5mm CORD



COMPATIBLE
APPLIANCES



DO NOT
OVERLOAD

COLOUR RANGE | MULTIPLUGS & ADAPTORS

PRODUCT CODE	DESCRIPTION	ITEM BARCODE	FEATURES
EE019P	5m MEDIUM DUTY EXTENSION LEAD 16 AMP – PINK	6009881090135	SAFETY SHUTTERED / LED POWER ON INDICATOR / 16 AMP 1.5MM CORD
EE019BL	5m MEDIUM DUTY EXTENSION LEAD 16 AMP – BLUE	6009881090142	
EE019OR	5m MEDIUM DUTY EXTENSION LEAD 16 AMP – ORANGE	6009881090159	
EE019GR	5m MEDIUM DUTY EXTENSION LEAD 16 AMP – GREEN	6009881090166	
EE019BLK	5m MEDIUM DUTY EXTENSION LEAD 16 AMP – BLACK	6009881090173	



Colour RANGE

3M MEDIUM DUTY EXTENSION LEAD 10 AMP



COMPATIBLE APPLIANCES

DO NOT OVERLOAD

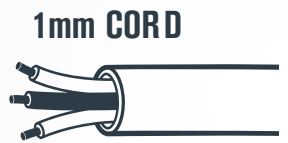

PRODUCT CODE	DESCRIPTION	ITEM BARCODE	FEATURES
EE022P	3m MEDIUM DUTY EXTENSION LEAD 10 AMP – PINK	6009881090180	SAFETY SHUTTERED / LED POWER ON INDICATOR / 10 AMP 1.0MM CORD
EE022BL	3m MEDIUM DUTY EXTENSION LEAD 10 AMP – BLUE	6009881090197	
EE022OR	3m MEDIUM DUTY EXTENSION LEAD 10 AMP – ORANGE	6009881090203	
EE022GR	3m MEDIUM DUTY EXTENSION LEAD 10 AMP – GREEN	6009881090210	
EE022BLK	3m MEDIUM DUTY EXTENSION LEAD 10 AMP – BLACK	6009881090227	

Colour RANGE



1 YEAR
WARRANTY

5M MEDIUM DUTY EXTENSION LEAD 10 AMP



COMPATIBLE
APPLIANCES



DO NOT
OVERLOAD

1mm CORD



PRODUCT CODE	DESCRIPTION	ITEM BARCODE	FEATURES
EE023P	5m MEDIUM DUTY EXTENSION LEAD 10 AMP – PINK	6009881090234	SAFETY SHUTTERED / LED POWER ON INDICATOR / 10 AMP 1.0MM CORD
EE023BL	5m MEDIUM DUTY EXTENSION LEAD 10 AMP – BLUE	6009881090241	
EE023OR	5m MEDIUM DUTY EXTENSION LEAD 10 AMP – ORANGE	6009881090258	
EE023GR	5m MEDIUM DUTY EXTENSION LEAD 10 AMP – GREEN	6009881090265	
EE023BLK	5m MEDIUM DUTY EXTENSION LEAD 10 AMP – BLACK	6009881090272	

GOLOUR RANGE | MULTIPLUGS & ADAPTORS



1 YEAR WARRANTY



CASSETTE EXTENSION REEL

LIGHT DUTY | 10 AMP CABLE

EXTENSION REELS | PRO MATE SERIES



Overload Protection



Safety Shuttered



Switched

PRODUCT CODE	DESCRIPTION	ITEM BARCODE	FEATURES
EER001A	10m CASSETTE EXTENSION REEL 10 AMP	6009880599707	SAFETY SHUTTERED / SINGLE SWITCH / WITH OVERLOAD PROTECTION
EER011	20m CASSETTE EXTENSION REEL 10 AMP	6009881090005	SAFETY SHUTTERED / SINGLE SWITCH / WITH OVERLOAD PROTECTION



1 YEAR WARRANTY

EXTENSION REEL

LIGHT DUTY | 10 AMP CABLE



EXTENSION REELS | PRO MATE SERIES



Overload Protection



Switched



Safety Shuttered

PRODUCT CODE	DESCRIPTION	ITEM BARCODE	FEATURES
EER007	15m EXTENSION REEL 10 AMP	6009880599721	SAFETY SHUTTERED / SINGLE SWITCH / WITH OVERLOAD PROTECTION
EER002	20m EXTENSION REEL 10 AMP	6009880599714	SAFETY SHUTTERED / SINGLE SWITCH / WITH OVERLOAD PROTECTION



1 YEAR WARRANTY



EXTENSION REEL

HEAVY DUTY | 16 AMP CABLE

EXTENSION REELS | PRO MATE SERIES

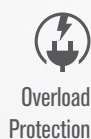

Overload Protection



Switched



Safety Shuttered

PRODUCT CODE	DESCRIPTION	ITEM BARCODE	FEATURES
EER009	25m HEAVY DUTY EXTENSION REEL 16 AMP	6009880599738	SAFETY SHUTTERED / SINGLE SWITCH / WITH OVERLOAD PROTECTION



1 YEAR WARRANTY

EXTENSION STEEL REEL

MEDIUM DUTY | 16 AMP CABLE



Overload Protection



Safety Shuttered



Switched

EXTENSION REELS | PRO MATE SERIES

PRODUCT CODE	DESCRIPTION	ITEM BARCODE	FEATURES
EER005	25m EXTENSION STEEL REEL MEDIUM DUTY 16 AMP CABLE	6009880968398	SAFETY SHUTTERED / SINGLE SWITCH / WITH OVERLOAD PROTECTION



1 YEAR WARRANTY



EXTENSION STEEL REEL

LIGHT DUTY | 10 AMP CABLE

EXTENSION REELS | PRO MATE SERIES



Overload Protection

Switched

Safety Shuttered

PRODUCT CODE	DESCRIPTION	ITEM BARCODE	FEATURES
EER013	20m EXTENSION STEEL REEL LIGHT DUTY 10AMP CABLE	6009880968381	SAFETY SHUTTERED / SINGLE SWITCH / WITH OVERLOAD PROTECTION

ELECTRICMATE

Power Perfected



Admin: +27(11) 681 9440 | Sales: +27(11) 681 9100

Email: info@matus.co.za

11 – 23 Andrea Road, Reuven Estate 2091, Johannesburg